

11.1 Instructions for installation of the recess box

1. Place the recess box into a pre-prepared hole in such a way that its outer edge is aligned with the rendering of the wall and secure it in place using appropriate cement, plaster, etc. Then finish and clean the opening up to the edge of the box.

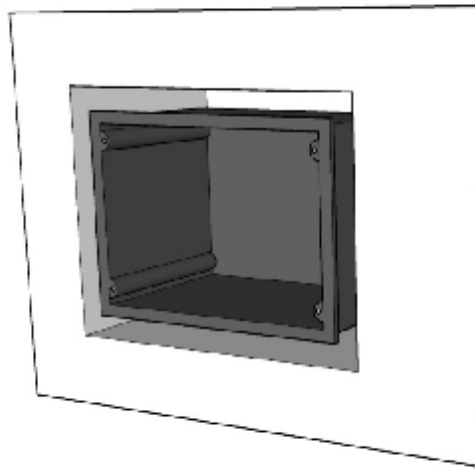

2. Use the 4 screws to attach the reduction frame to the recess box with the white dot facing upwards. Before tightening the screws, rotate the frame to align it in a horizontal position. Then tighten the screws.

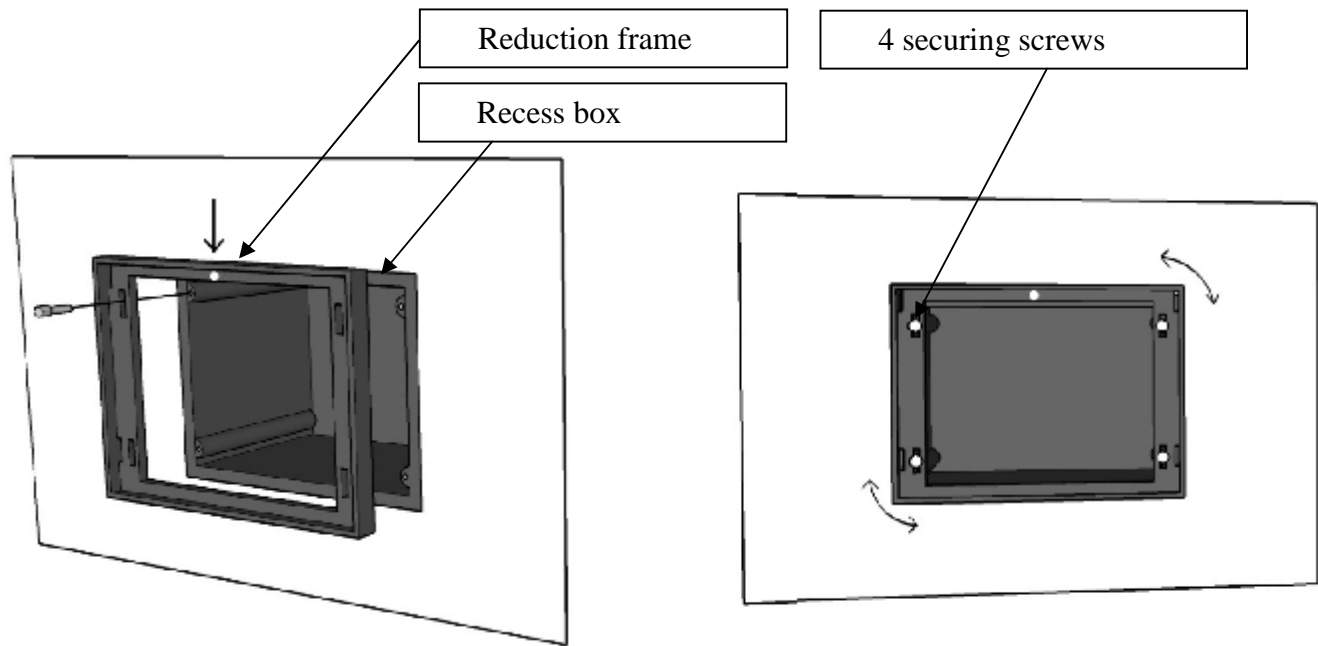

3. Before installation of the control unit, connect all cables, including the temperature sensor. Mount the control unit with the front panel on the frame by placing the hooks into the holes and pulling downward.

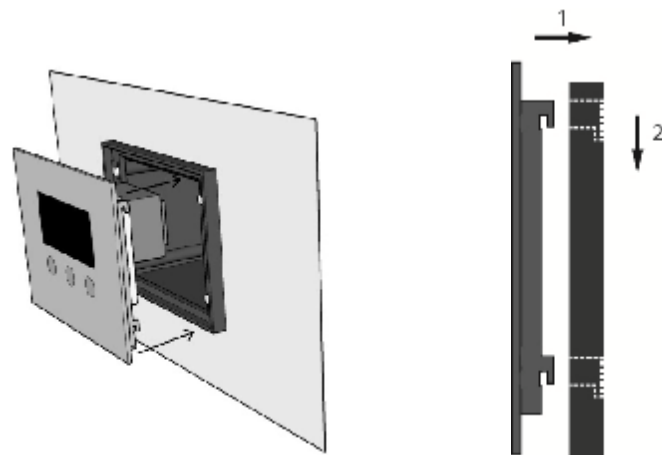

11.2 Description of Romotop DIRECT control unit components

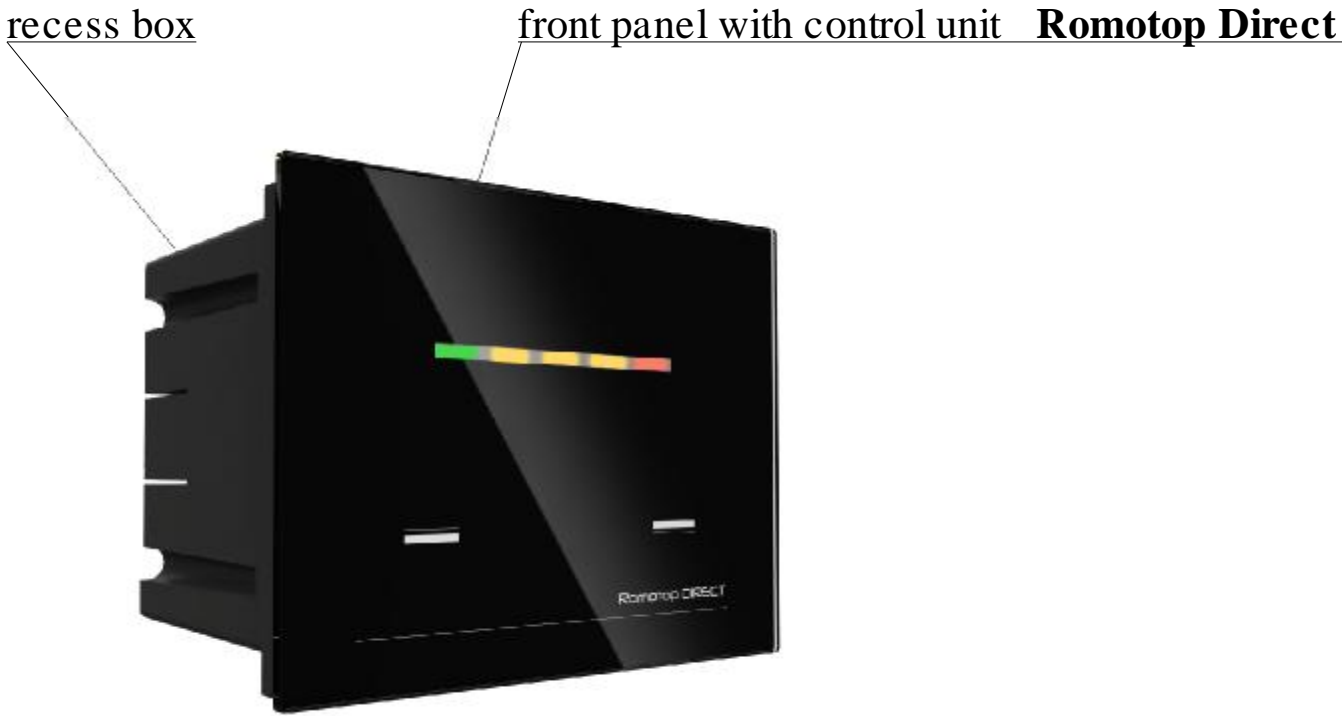

11.3 Dimensional drawing of the Romotop DIRECT control unit

